



KODAK ScanMate i1150WN Scanner vs. Canon imageFORMULA DR-C225W Scanner

COMPETITIVE CRUSH

Top Reasons to Buy

Top 5 Reasons to Buy from Kodak Alaris

Independent testing by Buyers Laboratory LLC (BLI) demonstrates multiple performance advantages for the **Kodak ScanMate i1150WN Scanner** when compared to the **Canon imageFORMULA DR-C225W Scanner**.

1. Superior Value and Accessibility

- The **ScanMate i1150WN** offers a standard 3-year limited warranty compared to a 1-year limited warranty on the **imageFORMULA DR-C225W**.
- Although both devices deliver wireless accessibility only the **ScanMate i1150WN** provides network connectivity thru an Ethernet connection, allowing for more users to gain access to the device.

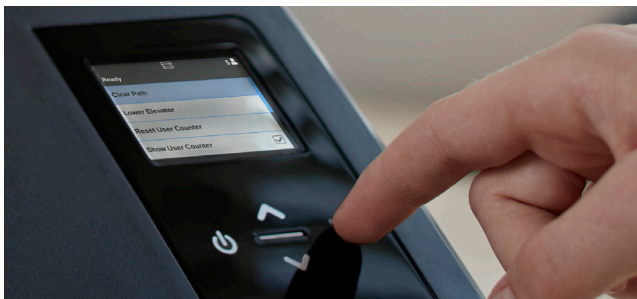

2. Providing a More Informative User Interface

- The **ScanMate i1150WN** offers a color touchscreen, which offers a description of the scan profile that is being selected along with accessing all 9 customizable scan profiles directly at the user interface
- The **Canon** model has no display screen and can only dedicate a single scan profile at time to the start button.

3. Better at Providing Structured Information

- Providing a Text Searchable document makes data more structured which makes it easier to find the information later.
- According to Buyers Laboratory LLC testing, the **ScanMate i1150WN** outperforms the **imageFORMULA DR-C225W** by over 25% when it comes to Optical Character Recognition accuracy of black text at 200dpi.

4. Scan More and Faster Than the Canon

- The **ScanMate i1150WN** holds 50 pages in the ADF, which is 40% more than the **imageFORMULA DR-C225W** which only holds 30.
- With the capability to sustain a daily duty cycle of 3,000 scans, the **ScanMate i1150WN** has a daily duty cycle 50% greater than the **imageFORMULA DR-C225W**.

5. Reduced processing time with smaller scan file size.

- According to testing performed by Buyers Laboratory LLC, the **ScanMate** i1150WN Scanner has smaller file sizes no matter which settings are used.
- A single page scanned using the Auto Color Mode is 12 - 25 times smaller using the **ScanMate** i1150WN. If customers are scanning lots of single page documents using the auto color settings, the i1150WN is the proven winner according to BLI when it comes to file size.

File Size in KB	Kodak Alaris		Canon	
	200 dpi		300 dpi	
Single-Page Black	26	36	41	47
Single-Page Grayscale	180	277	339	541
Single-Page Color	222	308	387	585
Single-Page Auto Color	26	304	26	660
Multi-Page Black	688	1,024	1,024	1,341
Multi-Page Color	4,804	6,902	9,236	14,541
Multi-Page Auto Color	4,915	6,861	9,206	14,336



Real-World Situations Addressed And Answered.

As BLI's rigorous testing demonstrates, the **Kodak ScanMate** i1150 Scanner outperforms the **Canon imageFORMULA** DR-C225W Scanner and offers more benefits, including greater performance, higher productivity and real savings.

Want to learn more?

www.kodakalaris.com/go/i1150wn

Kodak Alaris Inc.

2400 Mt. Read Blvd., Rochester, NY 14615, USA
1-800-944-6171

Kodak Alaris Operations Canada Inc.

Mississauga, Ontario, Canada L5W 0A5
1-800-944-6171



[Learn more >](#)

NOTE: All data in this report were collected during independent testing by Buyers Laboratory LLC (BLI) in the company's 10,000 square-foot test facility in Hackensack, New Jersey. The products tested were the **Kodak ScanMate** i1150 Scanner and the **Canon imageFORMULA** DR-C225W Scanner. Test results and performance comparisons are validated by BLI and published with the company's written permission.

1. Total cost per scan is based on the unit's rated daily scan volume and U.S. pricing for list price, warranty and maintenance over a three-year period.
2. Average speed includes the tested speeds at 200 dpi and 300 dpi after initiating the scan from the PC and the unit's control panel hard key. Each batch is assumed to have been scanned 50% in color mode and 50% in black-and-white mode.
3. The gap release can be set to the open position to handle multiple documents at once.
4. File sizes are measured after scanning a 25-page document using default settings at 200 dpi and 300 dpi. Larger file sizes will impact data storage requirements and could cause network traffic congestion.

© 2016 Kodak Alaris Inc.
The Kodak trademark and trade dress are used under license from Eastman Kodak Company. 08/16

Kodak alaris